

9570679

TIP A

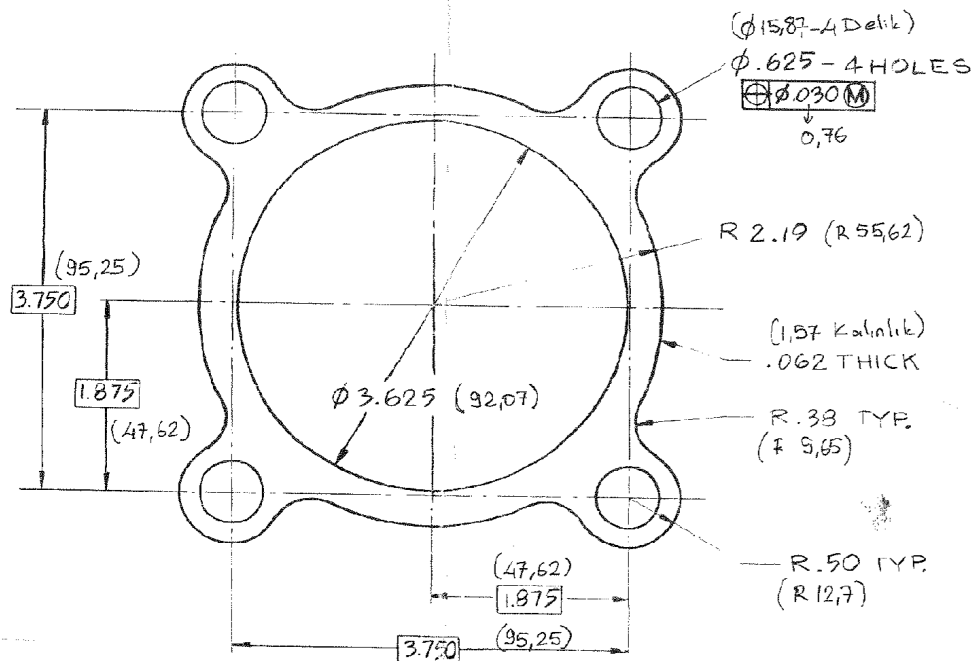

TIP B

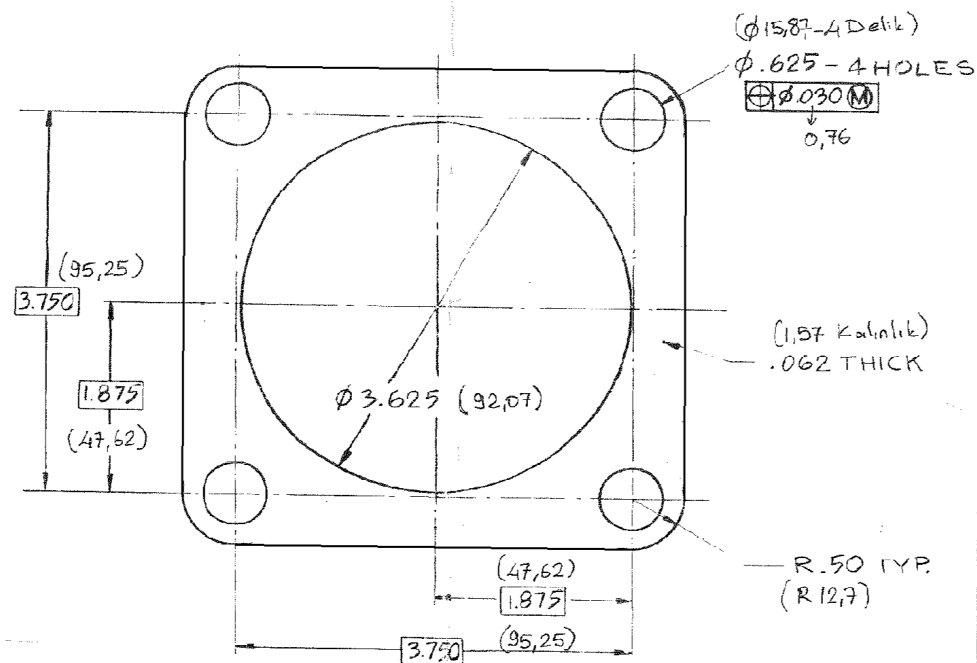

T B 1208

Yer No	Sıra No
	1 1564

RFC NO	REV LET	REVISION	DATE	BY	APVD
	A	Lokomotif Fb. 247922 sayılı yazı (19.09.24)			

TOLERANCE ON ALL DIMENSIONS NOT SPECIFIED ON THE DRAWING TO BE IN ACCORDANCE WITH A.I. 2403. BREAK ALL SHARP CORNERS UNLESS OTHERWISE SPECIFIED.

THE FOLLOWING ITEMS APPLY UNLESS OTHERWISE SPECIFIED:  
FOR DIAMETRAL FEATURES, ROUNDNESS MUST BE WITHIN THE MAXIMUM MATERIAL CONDITION AND MINIMUM MATERIAL CONDITION BOUNDARY.  
SEPARATE TRUE POSITION CALLOUTS MAY BE GAGED SEPARATELY, REGARDLESS OF DATUM REFERENCE.

GEOMETRIC DRAWING SYMBOLS:  
 □ FLAT / RUNOUT / TOTAL RUNOUT O ROUNDNESS  
 ∠ ANGULAR — STRAIGHT ● TRUE POSITION ∅ CYLINDRICAL  
 ⊙ CONCENTRIC ⊥ SQUARE ∅ DIAMETER // PARALLEL  
 △ PROFILE OF A SURFACE ○ PROFILE OF A LINE  
 ⊕ MAXIMUM MATERIAL CONDITION (MMC) □ DATUM IDENTIFICATION  
 ⊖ PROJECTED TOL. ZONE  
 ⊗ REGARDLESS OF FEATURE SIZE (RFS) [X] BASIC DIMENSION [AT] DATUM TARGET

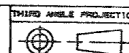

NO REGD	MATERIAL/NOTES	NAME OF PART	PART NO	ITEM NO
	MATERIAL EMS 629 GASKET	ELECTRO-MOTIVE A DIVISION OF GENERAL MOTORS CORP. LAGRANGE, ILLINOIS 60525, U.S.A.		
DR	B. SELES	DATE	PART NAME	
CK	E. Kester	17 OCT 84	GASKET	
SUP	MAK	31 OCT 84		
WELD		02 NO 84		
WATL				
	MOD ENGR BJS	11/1/84		
	ENGR JEX	09 NO 84		
		FIRST USED ON	PART NO	
		GP-38	9570679	

EMD 417M